



PERFECT CATERED AFFAIRS

## MEETING PLANNER'S GUIDE



[www.BranchedCatering.com](http://www.BranchedCatering.com)

123 Monmouth Road (Rt. #71). W. Long Branch, NJ 07764. Tel: 732-542-5050 FAX 5149

*Prices exclude 20% service charge and 6% sales tax. Prices subject to change.  
Branches is a smoke free facility.*

"I WISH TO THANK YOU AND YOUR STAFF FOR THE OPPORTUNITY TO HOLD THE PROGRAM EXECUTIVE OFFICE, INTELLIGENCE, ELECTRONIC WARFARE AND SENSORS (PEO IEW&S) SMALL BUSINESS INDUSTRY DAY AT BRANCHES ON THURSDAY, MARCH 20, 2003. THE CONFERENCE, ATTENDED BY APPROXIMATELY 200 PEOPLE FROM ACROSS THE US, WAS A HUGE SUCCESS DUE IN PART TO THE ATMOSPHERE OF QUALITY AND PROFESSIONALISM WE ENCOUNTERED FROM EVERY PERSON AT BRANCHES.

YOUR FACILITY WAS THE PERFECT PLACE TO HOLD OUR CONFERENCE, AND YOUR WILLINGNESS TO OFFER SPECIAL ACCOMMODATIONS TO HOST OUR INDIVIDUAL MEETINGS, CLASSROOM SESSIONS, BREAKS AND LUNCHEON WAS SINCERELY APPRECIATED. EVERYTHING WAS FIRST-CLASS - FROM THE DECOR OF EACH ROOM TO THE STATE OF THE ART AV EQUIPMENT, TO THE QUALITY OF FOOD AND EXCELLENT SERVICE."

- EDWARD T. BAIR  
PROGRAM EXECUTIVE OFFICER IEW&S



"OUR RECENT BUSINESS DINNER WAS EXECUTED PERFECTLY BY BRANCHES! THE AUDIO/VISUAL, ROOM, SETUP, FOOD AND AMBIENCE ALL COMBINED TO MAKE A PERFECT BALANCE FOR OUR EVENT."

- LARRY BUCCHERI, PARTNER  
THE MONMOUTH GROUP



"...THE EVENT WAS A TREMENDOUS SUCCESS AND IT REALLY GAVE ME GREAT PLEASURE TO HELP INTRODUCE THE NEW BRANCHES TO THE BUSINESS COMMUNITY. THE PRAISE FOR THE NEW DÉCOR, SOUND SYSTEM, EXCELLENT FOOD AND FANTASTIC SERVICE WAS UNANIMOUS - I HAVE NO DOUBT BRANCHES WILL FAST BECOME ONE OF MONMOUTH COUNTY'S MOST POPULAR LOCATIONS FOR SPECIAL EVENTS."

- LYNDA ROSE, PRESIDENT AND COO  
EASTERN MONMOUTH AREA CHAMBER  
OF COMMERCE

"THANK YOU FOR PROVIDING OUR ASSOCIATION WITH A MOST ENJOYABLE EVENING OF DINING AND DANCING. BOTH THE DINNER AND SERVICE WERE OUTSTANDING. I WOULD AT THIS TIME LIKE TO MAKE A BOOKING FOR NEXT YEAR."

- GAIL BORLINGHAUS, VP PURCHASING  
ENGINEERING AND PROFESSIONAL SERVICES



"ON BEHALF OF THE NJNG GASLIGHT CLUB, THANK YOU FOR THE LOVELY BRUNCH. THE FOOD WAS DELICIOUS AND OUR MEMBERS HAD A GREAT TIME..... THANKS AGAIN TO YOU AND YOUR STAFF FOR MAKING THIS A SPECIAL EVENT. WE LOOK FORWARD TO WORKING WITH YOU AGAIN IN THE FUTURE."

- THOMAS F. HAYES, DIRECTOR  
CONSUMER AND COMMUNITY RELATIONS  
NEW JERSEY NATURAL GAS



"...THANKS SO MUCH FOR HAVING THE QUARTERLY LUNCHEON AT YOUR BEAUTIFUL NEW FACILITY RECENTLY. THE FOOD WAS WONDERFUL (BUT I KNEW THAT WAS GOING TO BE THE CASE BEFOREHAND!) AND I ESPECIALLY THANK YOU FOR BEING SO ACCOMMODATING EACH TIME SOMEONE ELSE SHOWED UP UNEXPECTEDLY AT THE DOOR."

- MARSHA L. SAMITT, EXECUTIVE DIRECTOR  
GREATER OCEAN TOWNSHIP CHAMBER OF  
COMMERCE



"BRANCHES IS A GREAT PLACE TO HAVE AN EVENT! THE (JOB) FAIR WAS A TREMENDOUS SUCCESS DUE IN GREAT PART TO YOUR FABULOUS FACILITY AND PROFESSIONAL STAFF. WE WERE SO PLEASED THAT WE HAVE BOOKED BRANCHES FOR TWO MORE EVENTS."

- MIKE BESON  
JERSEY JOB GUIDE



# *Branches* ... FOR BUSINESS

FLEXIBILITY IS THE KEY WHEN DEALING WITH  
THE EVENT PLANNERS AT BRANCHES.

A VERSATILE AND FULLY RENOVATED FACILITY, BRANCHES IS A DESIRABLE ALTERNATIVE TO HOTEL BALLROOMS, RESTAURANT MEETING ROOMS AND CORPORATE OFFICE SUITES. THIS NEW SPECIAL EVENT AND CONFERENCE FACILITY, LOCATED JUST OFF GARDEN STATE PARKWAY EXIT 105, IS LESS THAN 90 MINUTES FROM NEW YORK CITY, ATLANTIC CITY AND PHILADELPHIA.

BRANCHES OFFERS A PRESTIGIOUS AND PRIVATE ATMOSPHERE WITH 14,000 SQUARE FEET OF FLEXIBLE BANQUET/MEETING SPACE. THERE IS PLENTY OF PARKING AND NO INTERFERENCE FROM HOTEL OR RESTAURANT TRAFFIC. YOU WILL ALWAYS HAVE ACCESS TO ADJUSTABLE LIGHTING, STATE OF THE ART AUDIO/VISUAL EQUIPMENT AND THE AVAILABILITY OF FREE WIRELESS INTERNET SERVICE.

YOU CAN COUNT ON PROFESSIONALS TO ASSIST WITH PLANNING, TO ACCOMMODATE LAST MINUTE CHANGES AND TO PROVIDE ONGOING SESSION SUPPORT. WE ARE EAGER TO SERVE YOU AND HAVE SPECIAL GUEST ROOM RATES AT NEARBY MAJOR HOTELS. FROM A BOARD MEETING OF 20 TO A FULL PROPERTY FUNCTION FOR 1,000, BRANCHES IS UNIQUELY QUALIFIED TO HOST ALL TYPES OF IMPORTANT SOCIAL AND CORPORATE EVENTS.



# Branches

## MEETING PACKAGES INCLUDE: (CUSTOMIZED PLANS ALSO AVAILABLE)

- COMPLIMENTARY MEETING ROOM (25+ ATTENDEES)
- UP TO 100 PAGES OF BLACK & WHITE PHOTOCOPYING AT NO CHARGE
- ROLLING PRESENTATION BOARD (MAGNETIC - ERASABLE ONE SIDE, CORK ON REVERSE)
- ONE PROJECTOR SCREEN
- ROLLING PROJECTOR TABLE
- ONE MICROPHONE
- FLIP CHART

### **MORNING PLAN - 7:30 - 11:00 a.m. .... \$15++ PER PERSON\***

- ✓ CONTINENTAL BREAKFAST; COFFEE, TEA, JUICE, FRUIT, HOMEMADE BREAKFAST PASTRIES, BAGELS
- ✓ MID-MORNING BREAK; FRESH BAKED COOKIES, ENERGY BARS, FRESH FRUIT, SODA, JUICE & BOTTLED WATER

### **AFTERNOON PLAN - 12:00 - 4:00 p.m. .... \$31++ PER PERSON\***

- ✓ LUNCHEON UPON ARRIVAL (PRE-ORDER, BUFFET OR PLATED; YOUR MEETING PLANNER WILL ADVISE)
- ✓ MID-AFTERNOON BREAK; COFFEE, TEA, FRESH BAKED COOKIES, ENERGY BARS, FRESH FRUIT, SODA, JUICE & BOTTLED WATER

### **FULL DAY PLAN - 7:30 - 4:00 p.m. .... \$46++ PER PERSON\***

- ✓ CONTINENTAL BREAKFAST; COFFEE, TEA, JUICE, FRUIT, HOMEMADE BREAKFAST PASTRIES, BAGELS
- ✓ MID MORNING BREAK; FRESH BAKED COOKIES, ENERGY BARS, FRESH FRUIT, SODA & JUICE
- ✓ LUNCHEON (PRE-ORDER, BUFFET OR PLATED; YOUR MEETING PLANNER WILL ADVISE)
- ✓ MID-AFTERNOON BREAK; FRESH BAKED COOKIES, ENERGY BARS, FRUIT, COFFEE, TEA, SODA, JUICE & BOTTLED WATER

### **EVENING PLAN - 5:00 - 9:00 p.m. .... \$35++ PER PERSON\***

- ✓ IMPORTED & DOMESTIC CHEESE DISPLAY, FRESH FRUIT OR VEGETABLE CRUDITÉ
- ✓ DINNER (PRE-ORDER, BUFFET OR PLATED; YOUR MEETING PLANNER WILL ADVISE)
- ✓ CHEF'S DESSERT CREATION WITH COFFEE & TEA

ITEMS AND PRICES ARE SUBJECT TO CHANGE. NJ SALES TAX & 20% SERVICE CHARGE ARE NOT INCLUDED

**SPECIALTY BREAKS AND OPTIONS AVAILABLE**



# Branches...FOR BUSINESS

- ❑ WIRELESS AND HARD-WIRED INTERNET & SOUND SYSTEM
- ❑ DMX DIGITAL MUSIC SERVICE IN EACH ROOM
- ❑ DUAL (MEETING & AMBIENCE) LIGHTING CAPABILITY
- ❑ ROOM-CENTERED ELECTRICAL OUTLETS
- ❑ DISTINCTIVE MEETING AND BREAKOUT SPACE
- ❑ DEDICATED ON-SITE PARKING
- ❑ FULL RANGE OF A/V EQUIPMENT AVAILABLE FOR ADDITIONAL CHARGE
- ❑ ALA CARTE STYLE ESCOFFIER MENU ENHANCEMENT
- ❑ PRIVATE MEETING COORDINATOR
- ❑ EVENTS FROM 10 TO 500
- ❑ STORAGE FOR MATERIALS, PROPS, ETC. IN BETWEEN MEETINGS

## HOTEL ACCOMMODATIONS

ALL OF THE LISTED HOTEL PROPERTIES ARE WITHIN A 10-MINUTE DRIVE OF BRANCHES. PLEASE CONTACT THEM DIRECTLY. RATES AND PAYMENTS ARE HANDLED THROUGH THE HOTEL.

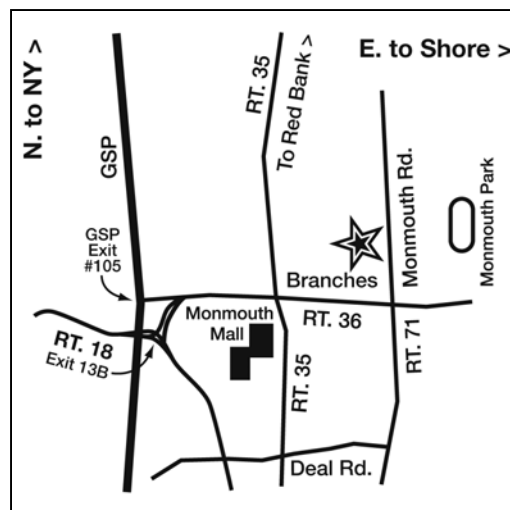

1. HOLIDAY INN - 700 HOPE ROAD, TINTON FALLS, NJ 07724  
CONTACT: 732-544-9300 SHUTTLE AVAILABLE
2. MARRIOTT COURTYARD - 600 HOPE ROAD, TINTON FALLS, NJ 07724  
CONTACT: 732-389-2100 X 621 SHUTTLE AVAILABLE
3. OCEAN PLACE CONFERENCE RESORT - ONE OCEAN BLVD., LONG BRANCH, NJ 07740  
CONTACT: 732-571-8974 SHUTTLE AVAILABLE
4. SHERATON - 6 INDUSTRIAL WAY WEST, EATONTOWN, NJ 07724  
CONTACT: 732-544-2607
5. STAYBRIDGE SUITES - 4 INDUSTRIAL WAY WEST, EATONTOWN, NJ 07724  
CONTACT: 732-380-9300



www.BranchesCatering.com

123 Monmouth Road (Rt. #71). W. Long Branch, NJ 07764. Tel: 732-542-5050 FAX 5149

Prices exclude 20% service charge and 6% sales tax. Prices subject to change.  
Branches is a smoke free facility.

# Branches

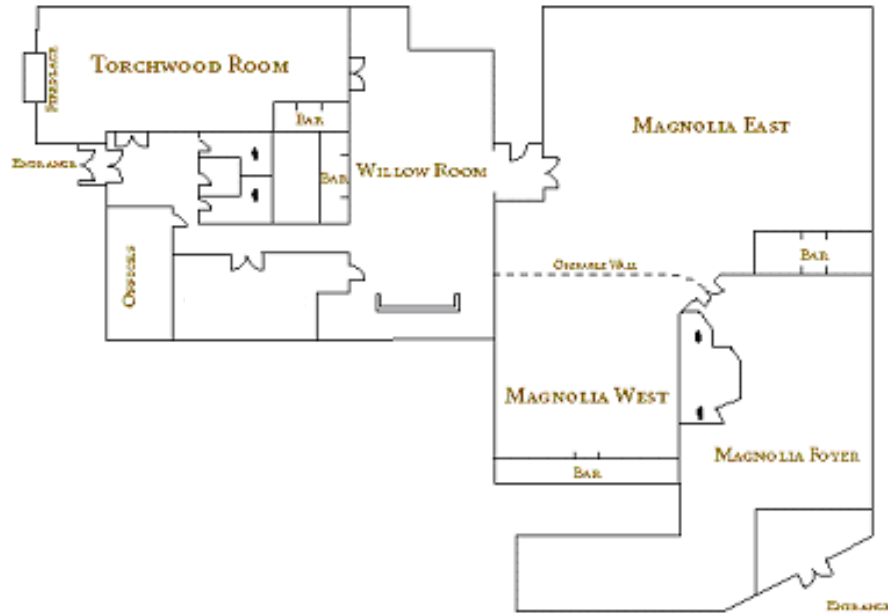

	SIZE IN SQ. FT.	ROUNDS OF 6-10	AUDITORIUM STYLE	CONFERENCE OR HOLLOW	U-SHAPED	CLASSROOM	WIRELESS SOUND	WIRELESS INTERNET
TORCHWOOD	2000	85	175	42	62	75	YES	YES
WILLOW ROOM	1800	125	175	42	62	70	YES	YES
MAGNOLIA BALLROOM EAST	3500	270	625	YES	YES	400	YES	YES
MAGNOLIA BALLROOM WEST	3500	100	150	48	65	75	YES	YES
MAGNOLIA BALLROOM	5800	420	800	YES	YES	500	YES	YES

CAPACITIES ARE APPROXIMATE AND DEPEND ON A VARIETY OF FACTORS.  
 FOR PICNICS AND RECEPTION USES, PLEASE INQUIRE. ALCOHOLIC BEVERAGES MAY ALSO BE SERVED IN OUTDOOR AREAS.



123 Monmouth Road (Rt. #71). W. Long Branch, NJ 07764. Tel: 732-542-5050 FAX 5149

Prices exclude 20% service charge and 6% sales tax. Prices subject to change.  
 Branches is a smoke free facility.

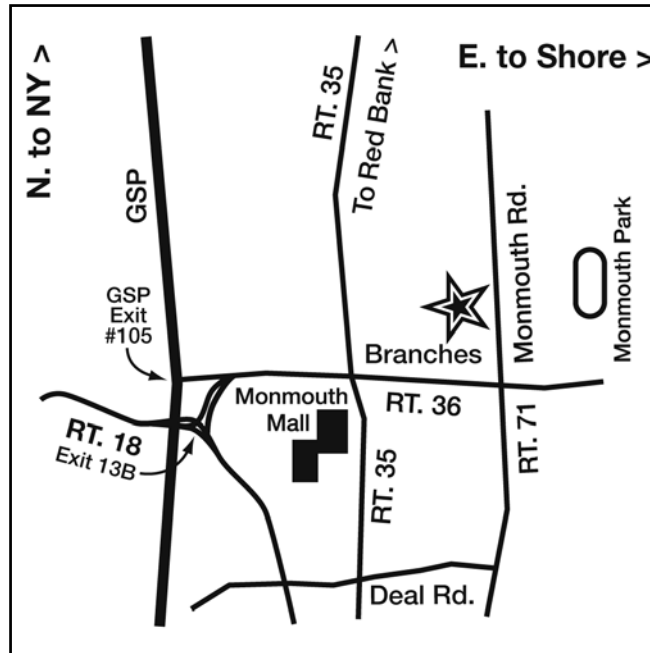

20 MINUTES FROM FREEHOLD

### DIRECTIONS TO BRANCHES

**FROM THE NEW JERSEY TURNPIKE (NORTHERN NEW JERSEY/NY)**  
TAKE EXIT 11 TO THE GARDEN STATE PARKWAY SOUTH.

**FROM THE GARDEN STATE PARKWAY**  
TAKE EXIT 105. PROCEED EAST ON ROUTE 36 TO THE 6TH TRAFFIC LIGHT. MAKE A LEFT TURN AT THE GREEN LIGHT ONTO MONMOUTH ROAD (RTE.71 N). BRANCHES IS APPROXIMATELY 500 FEET ON YOUR LEFT.

**FROM THE NEW JERSEY TURNPIKE (SOUTHERN NEW JERSEY/PA)**  
TAKE EXIT 7A ONTO INTERSTATE 195 EAST. CONTINUE ON 195 EAST FOR APPROXIMATELY 30 MINUTES. TAKE EXIT FOR ROUTE 18 NORTH (EATONTOWN).

**FROM ROUTE 18**  
TAKE EXIT TOWARD EATONTOWN/LONG BRANCH. PROCEED EAST ON ROUTE 36 TO THE 5TH TRAFFIC LIGHT. MAKE A LEFT TURN ONTO MONMOUTH ROAD.



[www.BranchesCatering.com](http://www.BranchesCatering.com)

123 Monmouth Road (Rt. #71). W. Long Branch, NJ 07764. Tel: 732-542-5050 FAX 5149

Prices exclude 20% service charge and 6% sales tax. Prices subject to change.  
Branches is a smoke free facility.

